



DRAGON[®]

RANCO Ultra Lightweight Bottom Dump



SPECIFICATIONS:

MODEL: LW-SBD-40

GVWR: 77,500 LB.

CAPACITY: 25 Cubic Yards.

FRAME: Hi -Tensile Steel.

TUB SKIN: 16 Ga. Hi-Tensile Steel.

GATE: 10ga Hi-Tensile Steel.

BANG BOARD: 14ga Aluminum.

SHED PLATE: 16ga Aluminum.

FENDER: 12ga Aluminum Fender.

LANDING GEAR: Adjustable.

GATE SAFETY CHAIN: 3/8' Chain.

STINGER: 12' Bolt-on Stinger.

SUSPENSION: Hutch Tandem With Single Leaf Composite Spring.

AXLE: 5" Round, 71.5" Track, 16.5"X7" Brakes, Automatic Slack Adjusters, Duralite Hub w/Centrifuse Drums, Hub Piloted.

WHEEL: Aluminum Wheel.

TIRE: 445/50R22,5 Super Single.

GATE CONTROL: Versa Valve On Driver Side. Electrically Actuated From Truck Cab.

GATE CYLINDER: 8'X30' Composite Cylinder.

GATE AIR: hose 1/2' w/Quick Release Valve Per Cylinder.

BRAKE: ABS Brake System.

ELECTRICAL: DOT Approved 12 Volt. Led Lights

PLUMBING: DOT Approved System



ULTRALIGHTW • 3/17

tanktrailer.sales@modernusa.com • www.dragonproductsltd.com • 800-231-8198

U.S. owned and operated for over 50 years. © Copyright 2017 Modern Group Inc. All rights reserved.

RANCO Ultra Lightweight Bottom Dump

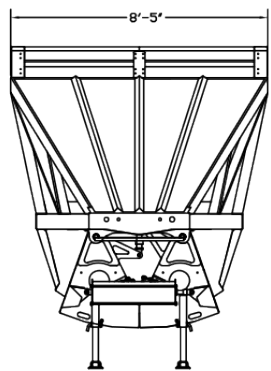
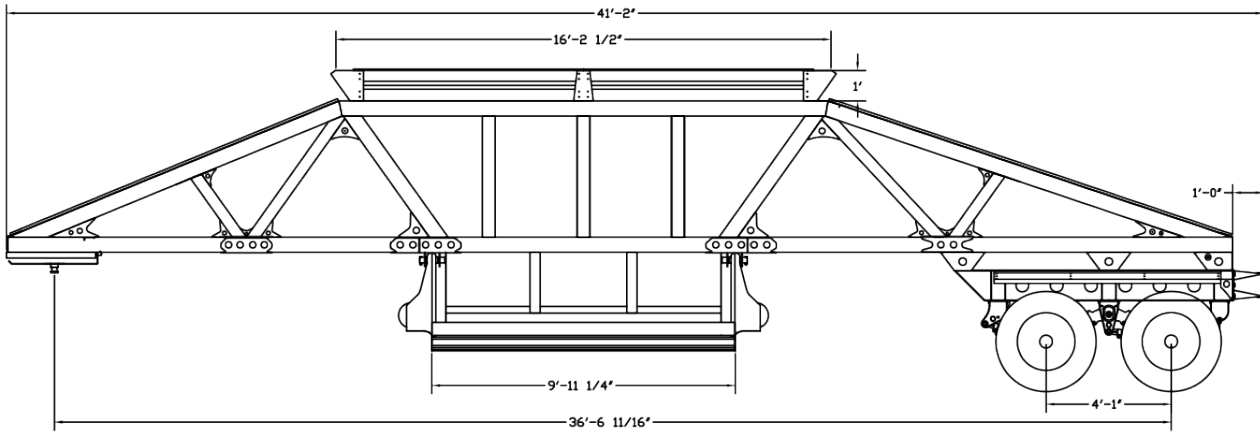

FRONT VIEW

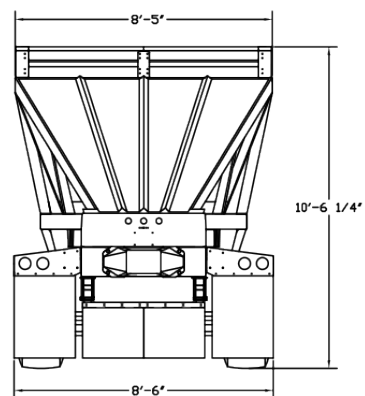

REAR VIEW



tanktrailer.sales@modernusa.com • www.dragonproductsltd.com • 800-231-8198

U.S. owned and operated for over 50 years. © Copyright 2017 Modern Group Inc. All rights reserved.